

**Product: TABLE**

Coffee tables in four sizes and two heights with metallic base and glass or ceramic top.

**TECHNICAL FEATURES**

**Top:** the top is available in a rectangular, square or round shape in back-lacquered etched glass or Ceramic.

**Base:** the base is in chromed or powder coated metal.



**DIMENSIONS**

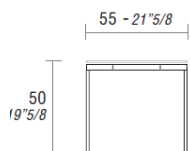

*DARWIN, square coffee table 55x55.*

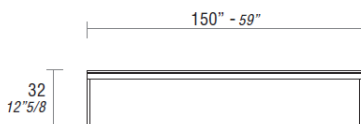

*DARWIN, rectangular coffee table.*

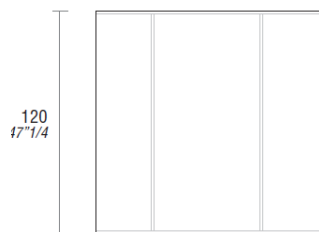
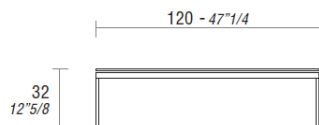

*DARWIN, square coffee table 120x120.*

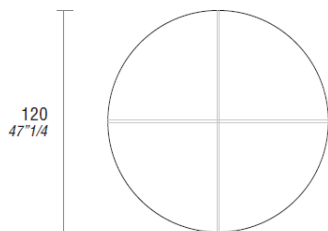
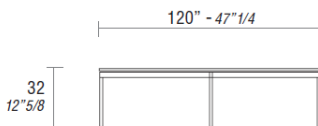

*DARWIN, round coffee table.*

**FINISHES**

**Top:**

**Back-lacquered etched glass:** White, Brown, Alfa Red, Silver, Titanio.

**Ceramica:** Calacatta Soft, Calacatta Glossy, Statuario Soft, Statuario Glossy Walks 1.0 White, Walks 1.0 Gray, Le Roche Ecrù, Ardoise Ecrù, Ardoise Noir, Nero Marquinia, Le Roche Grey, Industrial Ivory, Industrial Plomb.

**Base:** chromed or matt Carbon Glacè powder coated metal.